

BI-FOLD ALUMINUM PATIO OPENING

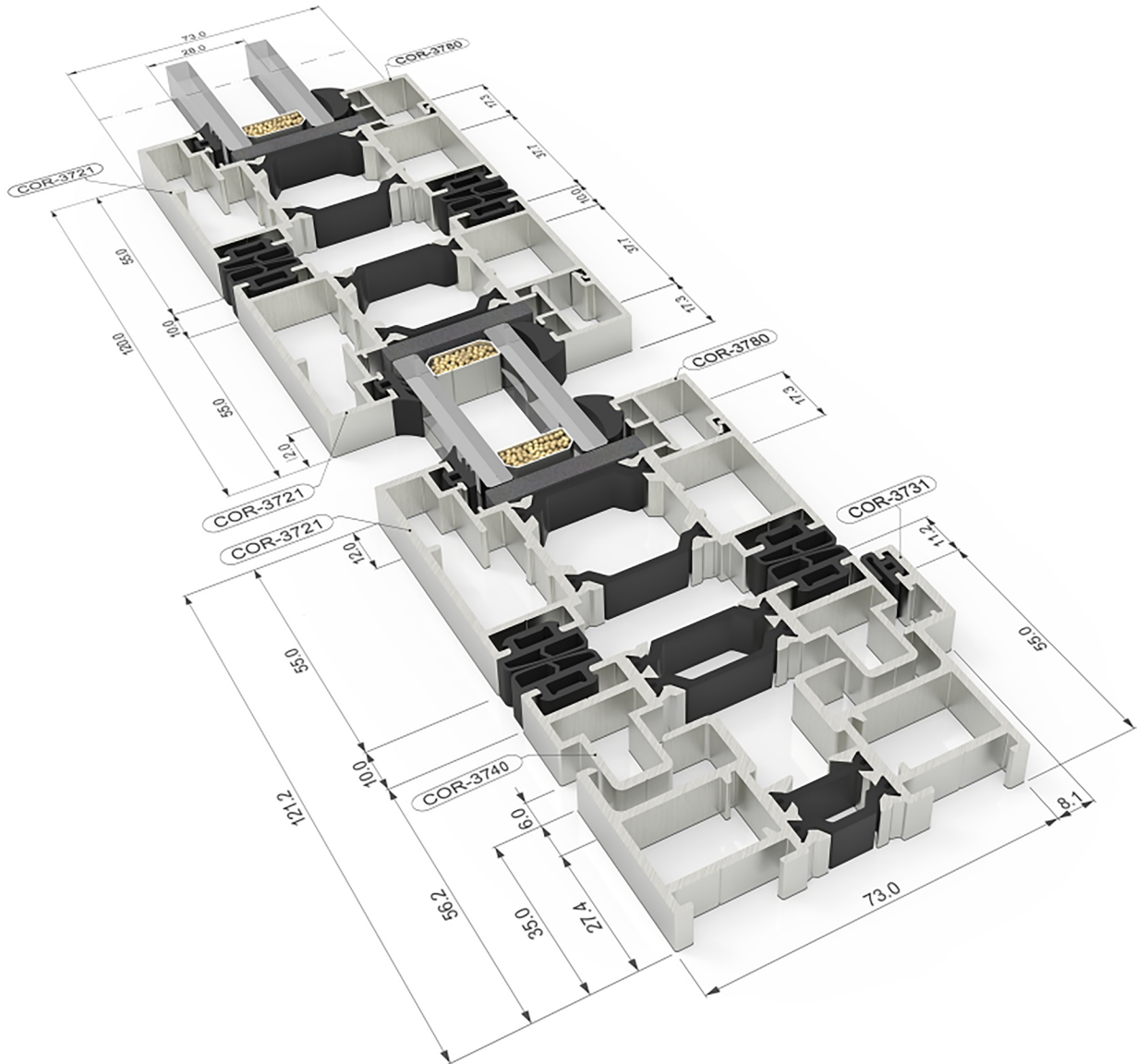

The Bi-Fold Star system is a high-performance aluminum-framed stackable bi-folding door system. It is designed for comfort and quality, durability, energy performance and security.

Energy Efficiency

Thermal Transmission Coefficient

Uw from 1.1 (W/m²K)

Please consult typology, dimensions and glazing

Acoustic Insulation

Maximum glazing: **55 mm**

Categories Achieved at Test Center

Protection against atmospheric agents

Air permeability (UNE-EN 12207): **Class 4**

Water tightness (UNE-EN 12208): **Class E₁₂₀₀**

Wind resistance (UNE-EN 12210): **Class C5**

Reference test: 2,700 x 2,530 mm. 3 sashes

Security test (PAS 24:2012): **Complies**

Reference test: 3 sashes. Configuration 330. 2,701 x 2,517 mm.

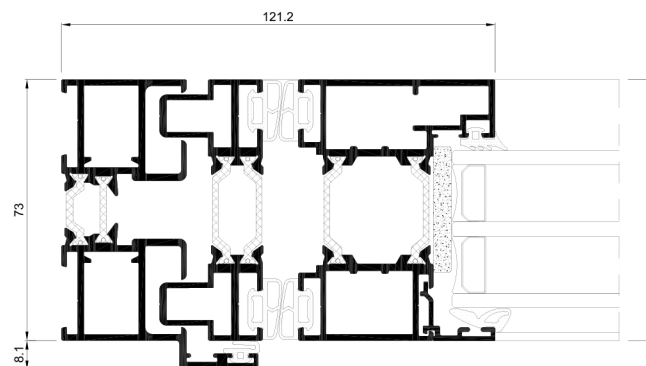

Sections	Frame 73 mm Sash 73 mm	Extrusion Alloy	6063 T-5
Profile Thickness	Door 1.8 mm	Polyamide Strip Length	Polyamide 6.6 reinforced with 25% fiberglass: Frame 20 mm Sash 30 mm
Maximum Dimensions	Width (L) = 1200 mm Height (H) = 3000 mm	Opening Possibilities	
Maximum Weight/Sash	120 Kg	Interior	1 to 14 sashes
Please consult regarding maximum weight and dimensions according to types		Exterior	1 to 14 sashes - Possibility of corner sash at 90° without mullion
Finishes	Colour powder coating (RAL, mottled, rough...) According to Qualicoat >60 microns Wood effect powder coating According to Qualideco standard Anodized According to Ewwa Euras Standard Class 15 Optionally Class 20 and 25 Optionally bicoloured	Accessibility	Possibility of embedded low threshold