

5 STAR ALUMINUM WINDOW AND BALCONY DOOR

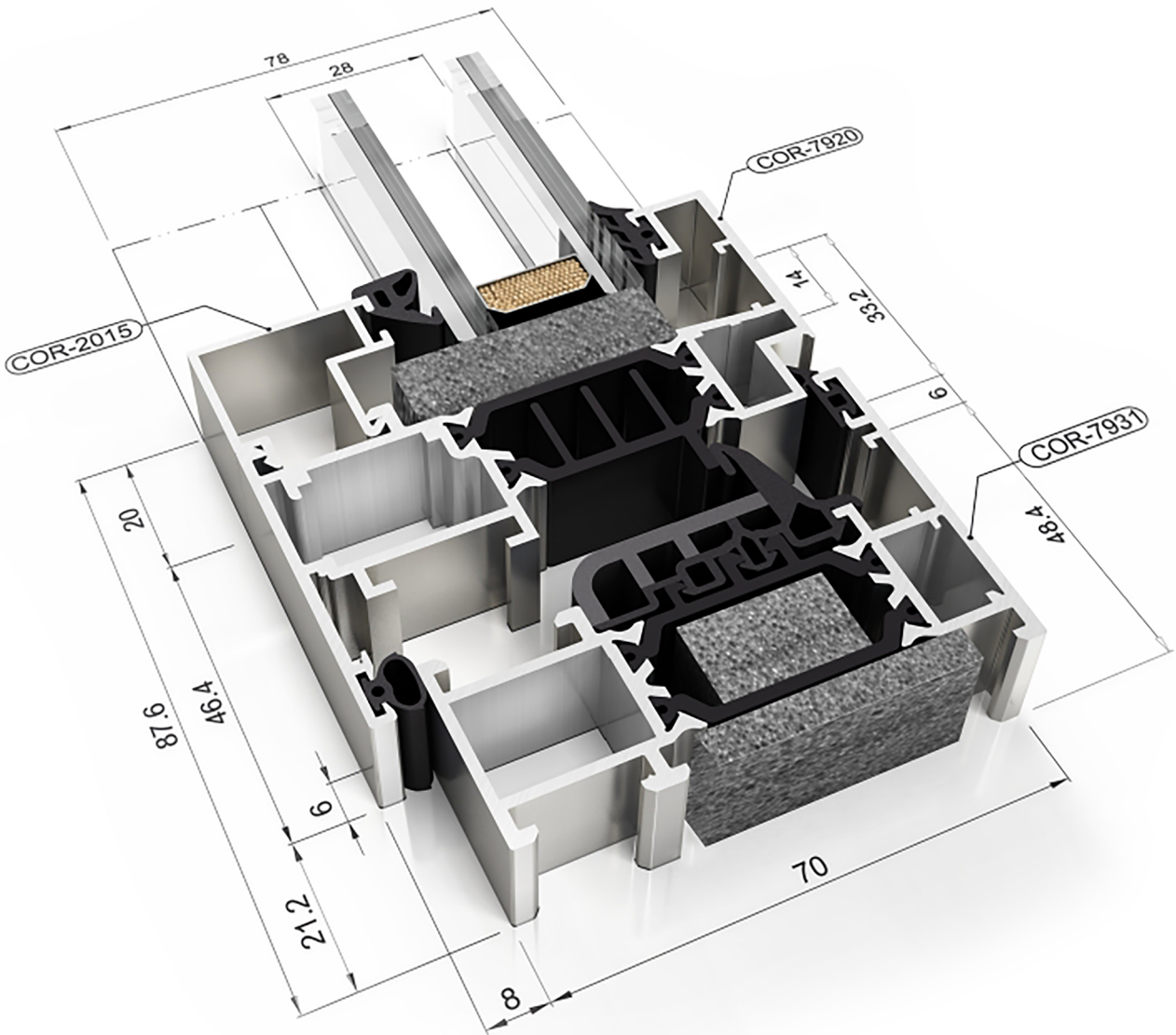

The 5 Star system is a high-performance aluminum-framed tilt and turn and fixed window and door system. It is designed for comfort and quality, durability, energy performance and security.

Energy Efficiency

Thermal Transmission Coefficient

Uw from 0.9 (W/m²K)

Please consult typology, dimensions and glazing

Acoustic Insulation

Maximum glazing: **55 mm**

Maximum acoustic insulation: **Rw = 44 dB**

Categories Achieved at Test Center

Protection against atmospheric agents

Air permeability (UNE-EN 12207): **Class 4**

Water tightness (UNE-EN 12208): **Class E₁₂₀₀**

Wind resistance (UNE-EN 12210): **Class C5**

Reference test: window 1.23 x 1.48 m. 2 sashes.

Burglar resistance (UNE-EN 1627): **Grade RC2 (WK2)**

Reference test: window 2.52 x 1.47 m. 1 sash with EVO SECURITY hardware.

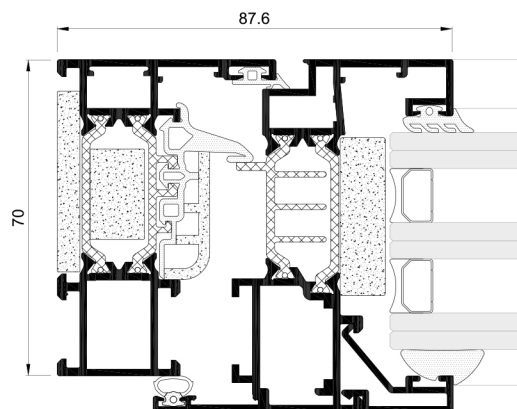

Sections	Frame 70 mm Sash 78 mm	Extrusion Alloy	6063 T-5
Profile Thickness	Window 1.5 mm Door 1.7 mm	Polyamide Strip Length	Polyamide 6.6 reinforced with 25% fiberglass: 32 to 35 mm
Maximum Dimensions	Width (L) = 1,500 mm Height (H) = 2,600 mm	Gaskets	EPDM triple gasket
Maximum Weight/Sash	160 Kg	Foams	Perimeter polyolefin foam in glazing rebate zone
Please consult regarding maximum weight and dimensions according to types		Opening Possibilities	
Finishes	Colour powder coating (RAL, mottled, rough...) According to Qualicoat >60 microns Wood effect powder coating According to Qualideco standard Anodized According to Ewwa Euras Standard Class 15 Optionally Class 20 and 25 Optionally bicoloured	Inwards	Side hung, turn&tilt, bi-fold, parallel-tilt and bottom hung
		Outwards	Side hung, top hung and pivoting on horizontal or vertical axis
Hardware	Optionally concealed hinges Optionally security hardware	AVIS Technique Certificate	DTA certification from CSTB lab Ref. 6/17 - 2363