

*Note: PHI certified systems c/w limited glazing options.
Contact your Sales Representative for more information



fenestration
canada
WESTECK WINDOWS MFG INC. 2017
MEMBER IN GOOD STANDING
THESE DRAWINGS ARE WESTECK'S
CONFIDENTIAL AND PROPRIETARY
INFORMATION AND SHALL NOT BE
GIVEN TO ANY OTHER PERSON OR
COMPANY WITHOUT WESTECK'S
PRIOR WRITTEN CONSENT

| REV. | DATE | DESCRIPTION |
|------|------|-------------|
| △ | - | - |
| △ | - | - |
| △ | - | - |
| △ | - | - |
| △ | - | - |

| |
|---|
| CUSTOMER APPROVAL (SIGNATURE) |
| Revolution XL PH - Picture Picture w/Single Mullion |
| Horizontal Section |

| | |
|-----------|------------|
| SCALE | 1:2 |
| DATE | 07-03-2019 |
| SALES REP | - |
| DRAWN BY | - |

| | |
|----------------|----|
| ORDER NUMBER | - |
| DRAWING NUMBER | D1 |

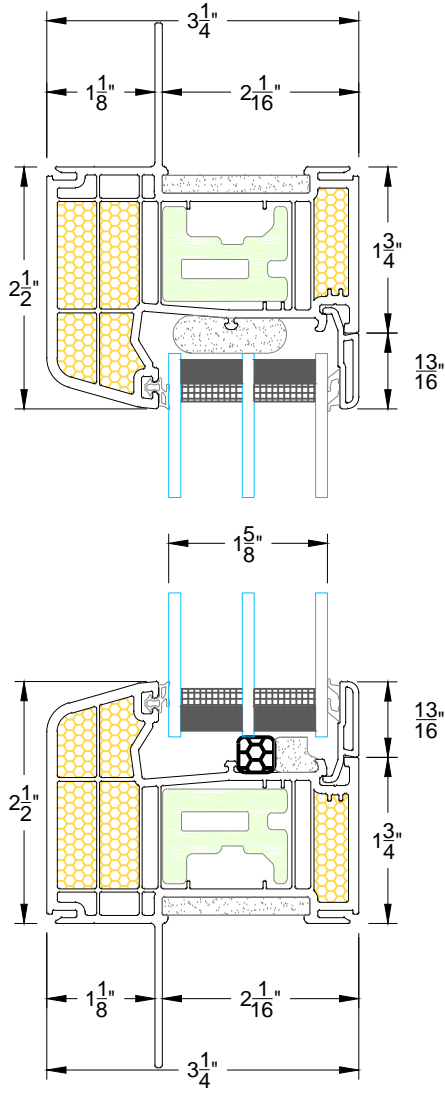

*Note: PHI certified systems c/w limited glazing options.
Contact your Sales Representative for more information



fenestration
canada
WESTECK WINDOWS MFG INC. 2017
MEMBER IN GOOD STANDING
THESE DRAWINGS ARE WESTECK'S
CONFIDENTIAL AND PROPRIETARY
INFORMATION AND SHALL NOT BE
GIVEN TO ANY OTHER PERSON OR
COMPANY WITHOUT WESTECK'S
PRIOR WRITTEN CONSENT

| REV. | DATE | DESCRIPTION |
|------|------|-------------|
| △ | - | - |
| △ | - | - |
| △ | - | - |
| △ | - | - |
| △ | - | - |

| |
|---|
| CUSTOMER APPROVAL (SIGNATURE) |
| Revolution XL PH - Picture Picture w/Single Mullion |
| Vertical Section |

| | |
|-----------|------------|
| SCALE | 1:2 |
| DATE | 07-03-2019 |
| SALES REP | - |
| DRAWN BY | - |

| | |
|----------------|----|
| ORDER NUMBER | - |
| DRAWING NUMBER | D2 |