

DETAILS ARE INTENDED TO SHOW A TYPICAL STRUCTURAL FASTENING METHOD OF RETAINING WINDOWS AND DOORS FOR WARRANTY PURPOSES ONLY. WATER PROOFING ENVELOPE DETAILS ARE TO BE COMPLETED BY OTHERS AND ARE NOT THE RESPONSIBILITY OF WESTECK WINDOWS & DOORS.

SEE PROJECT SPECIFIC ARCHITECTURAL AND ENVELOPE ENGINEERING DETAILS THAT PERTAIN TO WATERPROOFING SEQUENCING DETAILS. IT IS THE SOLE RESPONSIBILITY OF THE CONTRACTOR AND PRODUCT INSTALLER TO ENSURE ALL PRODUCTS ARE INSTALLED LEVEL, PLUMB AND SQUARE TO ALLOW FOR PROPER OPERATION AND FULL PRODUCT WARRANTY.

WESTECK WINDOWS & DOORS NEITHER ENDORSES NOR APPROVES OF ANY FASTENING METHOD THAT DEVIATES FROM THESE DETAILS WITHOUT WRITTEN CONSENT.

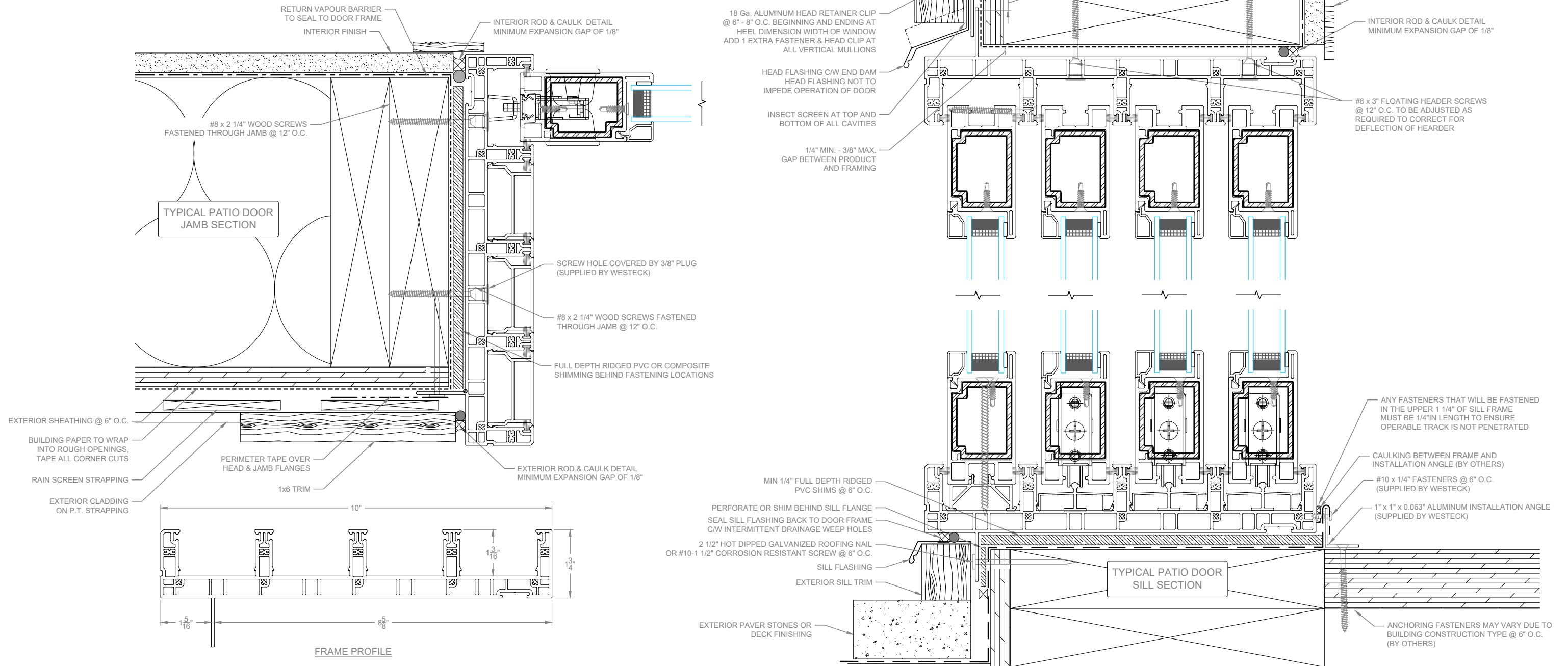

| REV. | DATE | DESCRIPTION | CHECKED | APPROVED |
|------|------|-------------|---------|----------|
| A | - | - | - | - |
| B | - | - | - | - |
| C | - | - | - | - |
| D | - | - | - | - |
| E | - | - | - | - |

GrandView MultiSlide Series - Part 9 Typical Installation Detail

XXXF Handing

Wood Sill

| | |
|-----------|------------|
| SCALE | 1:2.5 |
| DATE | 2020-11-04 |
| DRAWN BY | DougT |
| SALES REP | - |

DRAWING NUMBER

D1