

DETAILS ARE INTENDED TO SHOW A TYPICAL STRUCTURAL FASTENING METHOD OF RETAINING WINDOWS AND DOORS FOR WARRANTY PURPOSES ONLY. WATER PROOFING ENVELOPE DETAILS ARE TO BE COMPLETED BY OTHERS AND ARE NOT THE RESPONSIBILITY OF WESTECK WINDOWS & DOORS.

SEE PROJECT SPECIFIC ARCHITECTURAL AND ENVELOPE ENGINEERING DETAILS THAT PERTAIN TO WATERPROOFING SEQUENCING DETAILS. IT IS THE SOLE RESPONSIBILITY OF THE CONTRACTOR AND PRODUCT INSTALLER TO ENSURE ALL PRODUCTS ARE INSTALLED LEVEL, PLUMB AND SQUARE TO ALLOW FOR PROPER OPERATION AND FULL PRODUCT WARRANTY.

WESTECK WINDOWS & DOORS IS NOT RESPONSIBLE FOR THE MAINTAINING OF WATERPROOFING AND AIR/VAPOUR BARRIERS

WESTECK WINDOWS & DOORS NEITHER ENDORSES NOR APPROVES OF ANY FASTENING METHOD THAT DEVIATES FROM THESE DETAILS WITHOUT WRITTEN CONSENT.

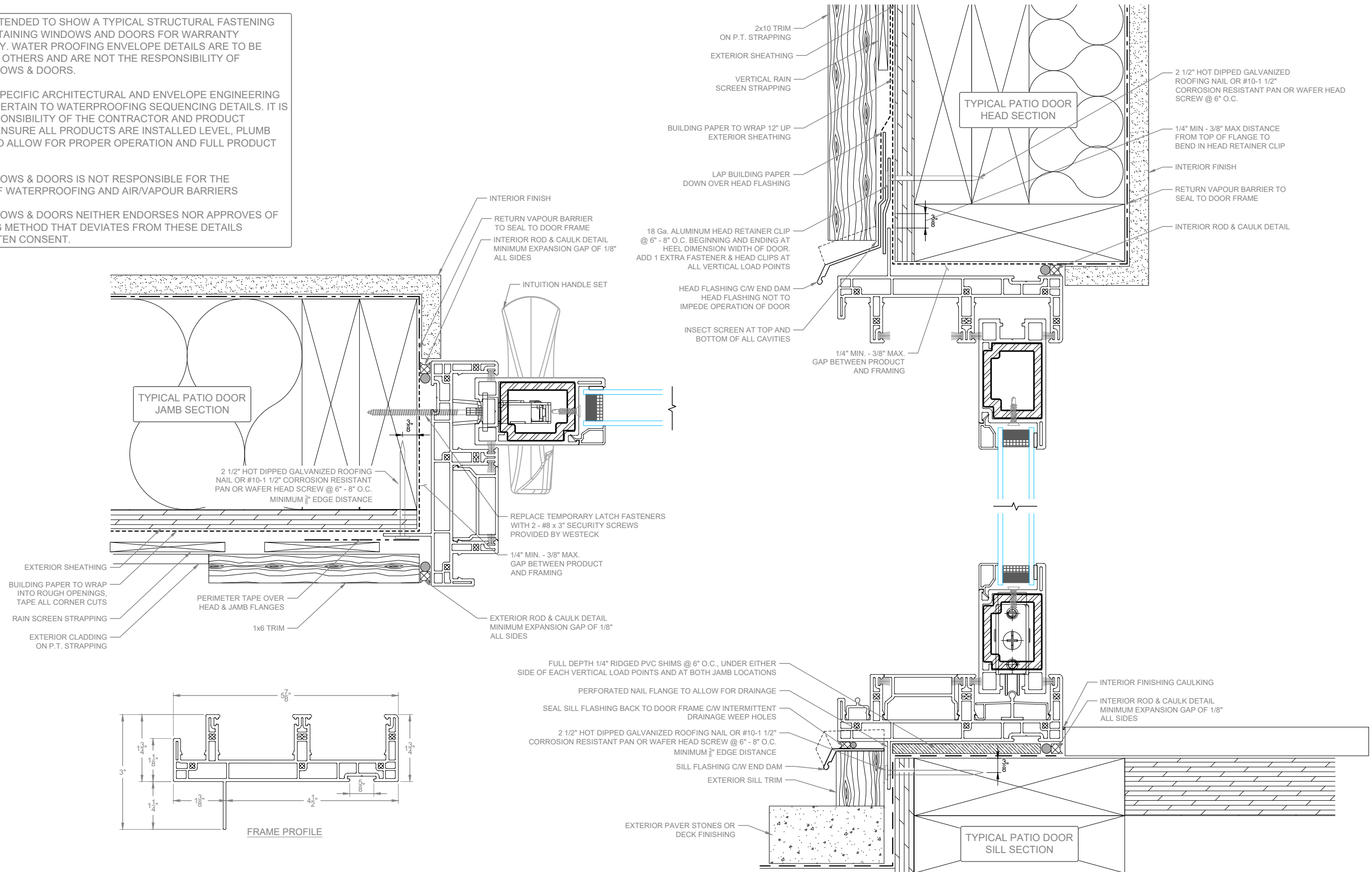

WESTECK WINDOWS MFG INC. 2020
MEMBER IN GOOD STANDING

THESE DRAWINGS ARE WESTECK'S CONFIDENTIAL AND PROPRIETARY INFORMATION AND SHALL NOT BE GIVEN TO ANY OTHER PERSON OR COMPANY WITHOUT WESTECK'S PRIOR WRITTEN CONSENT

REV.	DATE	DESCRIPTION	CHECKED	APPROVED
A	12-09-2020	Interim Sill Cover	-	-
B	-	-	-	-
C	-	-	-	-
D	-	-	-	-
E	-	-	-	-

425 Slide Series - Part 9 Typical Installation Detail

XO Configuration

Wood Sill

SCALE	1:2.5
DATE	02-10-2020
DRAWN BY	DougT
SALES REP	-

DRAWING NUMBER	D1
----------------	-----------