

PRODUCT ADJUSTMENT MANUAL

4300 Series/4300 Combo/6000 Series/7000 Series Casement Windows

Hinge Adjustment

The 4300 Casement Windows have 2 different adjustments. The vent hinges can be adjusted side to side using the Truth Hardware Casement Wrench (Truth Part#-31877) that was included in this Care & Maintenance Package. The vent can be moved laterally Left to Right using the wrench.

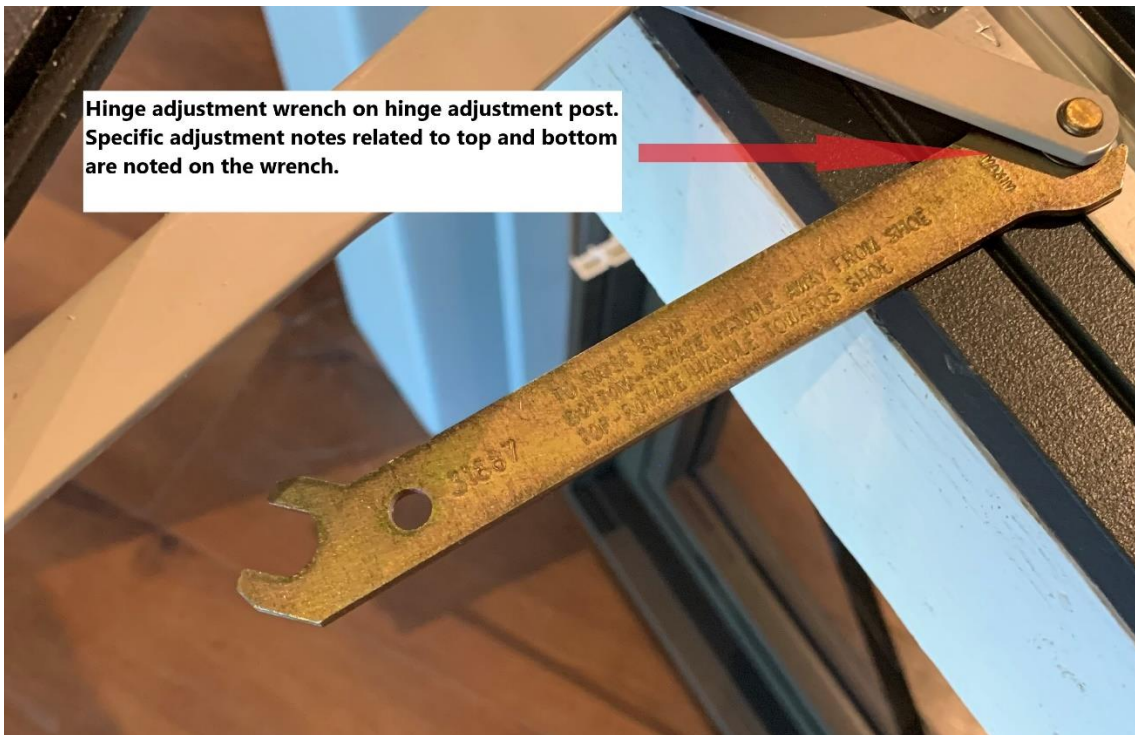

Bellingham | Chilliwack | Kelowna | Kirkland | Nanaimo | Vancouver | Victoria

Multi-point Lockbar Adjustment (4300 Series Casement and Combo Windows)

The multi-point lockbar is located on the jamb(s) of the Casement windows and, when selected, Awning windows. The lockbar will have anywhere from 2 to 5 locking points based on the overall height of the window. Each of these locking points have an adjustment that can be made using a TX20 Torx head bit. The cams have a notch in the side and turning to interior will tighten the seal and turning towards exterior will relax the seal





Head Office, Plant & Showroom
 8104 Evans Rd, Chilliwack, BC, V2R 5RB
 Phone: 1-604-792-6700 Fax: 1-604-792-6714
 Email: sales@westeckwindows.com
 Web: www.westeckwindows.com

GrandView MultiSlide and 425 Patio Doors

Panel wheel adjustments

For all sliding panels, the dual wheel roller set has an adjustment range of 19mm (3/4") up and down. The panels can be adjusted by using a #3 Philips screwdriver as seen in the picture below.



Bellingham | Chilliwack | Kelowna | Kirkland | Nanaimo | Vancouver | Victoria



Locking point adjustments:

Standard Hardware (comes standard on 425 Patio door; not available on GrandView Multislide):

There are 2 adjustments on the mortise keeper that is located on the locking jamb of the frame.

- 1) Adjust the vertical locking plane by loosening off the screws and adjusting the keeper up and down.
- 2) Adjust the horizontal locking plane by loosening or tightening the screws to allow the back plate to move in or out





Head Office, Plant & Showroom
8104 Evans Rd, Chilliwack, BC, V2R 5RB
Phone: 1-604-792-6700 Fax: 1-604-792-6714
Email: sales@westeckwindows.com
Web: www.westeckwindows.com

Premium Hardware (come standard on GrandView Multislide doors; upgrade option on 425 Patio door):

- 1) Adjust the vertical locking plane by loosening off the screws and adjusting the keeper up and down.
- 2) Adjust the horizontal locking plane by loosening or tightening the screw to adjust the throw of the locking mortise.

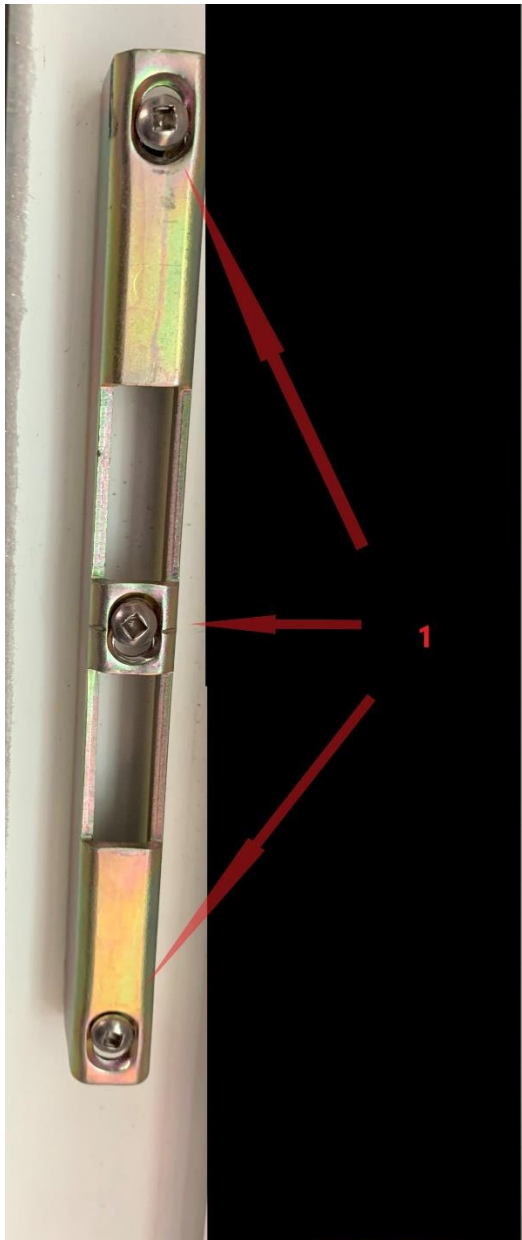

Bellingham | Chilliwack | Kelowna | Kirkland | Nanaimo | Vancouver | Victoria



RevXL Tilt & Turn Products (Windows and Doors)

Multi-point locking system adjustments

The adjustment cams have a notch in them and when turned towards the interior of home the seal increases and turning to the exterior the seal decreases.

Making Adjustments

B Locking point

TITAN iP, AF - comfort mushrooms

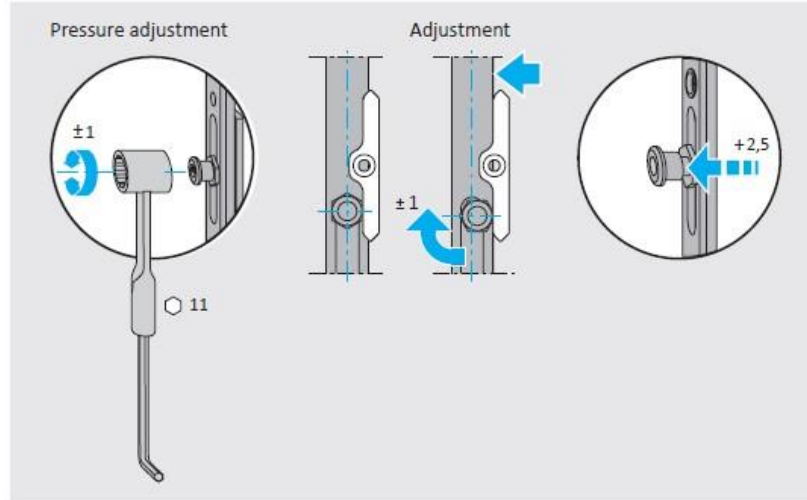

TITAN iP/FAVORIT

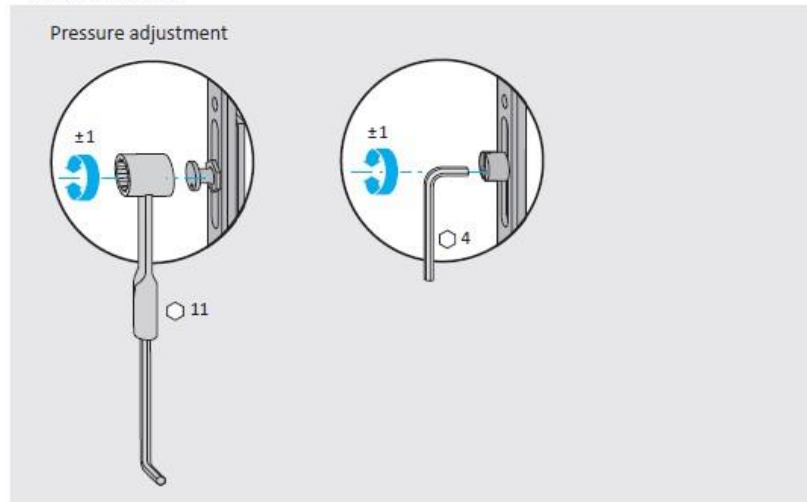

Vent adjustments (side to side, up and down as well as increase/decrease sealing pressure)

Making Adjustments

Stay

Hinge side axxent 24+

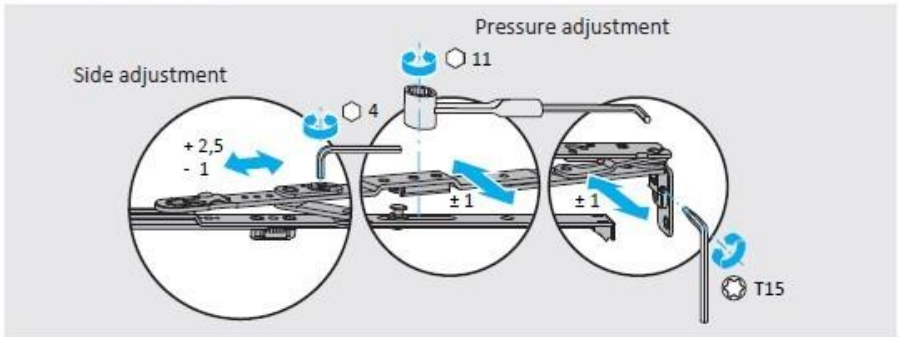

Hinge side axxent 34/axxent SE

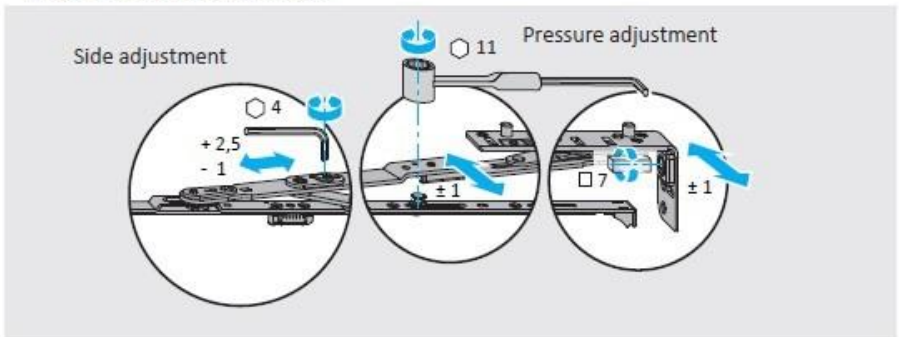

Bottom hinge/Corner hinge

Hinge side axxent 24+/axxent 34

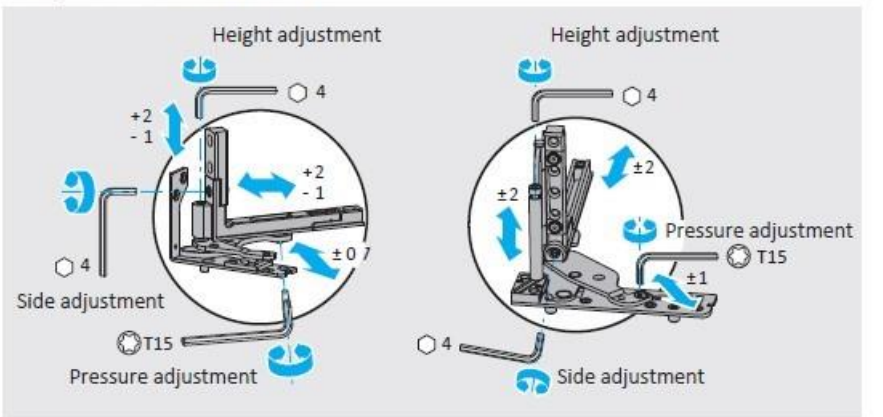

Bellingham | Chilliwack | Kelowna | Kirkland | Nanaimo | Vancouver | Victoria

