

\*ALL DRAWINGS VIEWED FROM THE EXTERIOR UNLESS OTHERWISE SPECIFIED\*

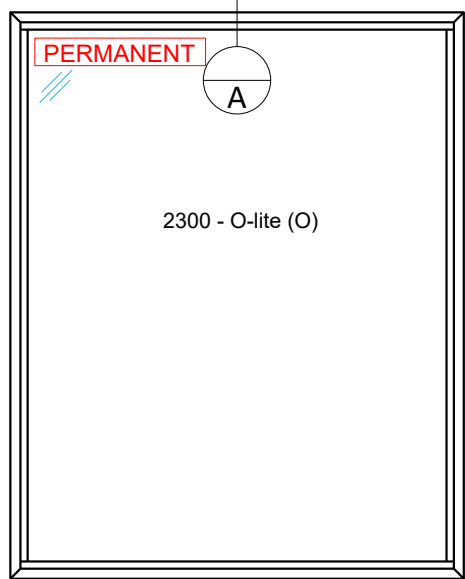

2300 - O-lite (O)

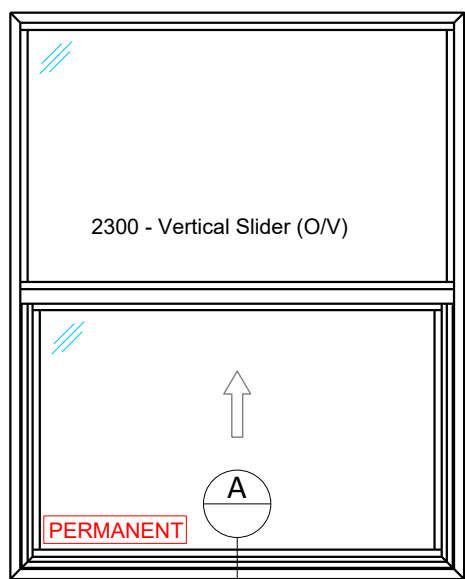
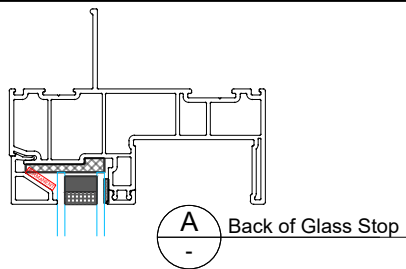

2300 - Vertical Slider (O/V)

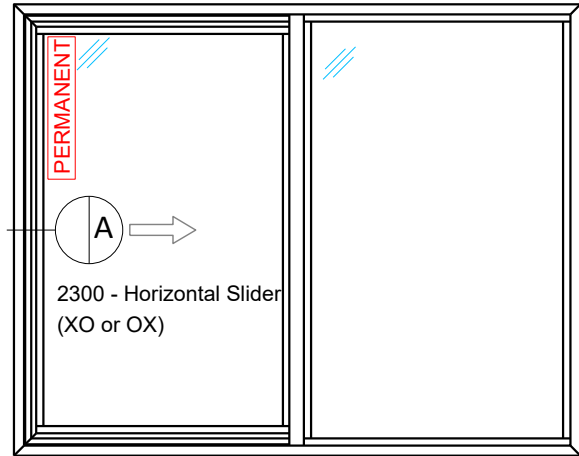
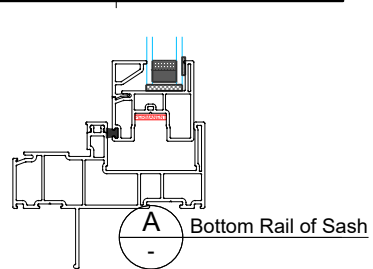

2300 - Horizontal Slider (XO or OX)

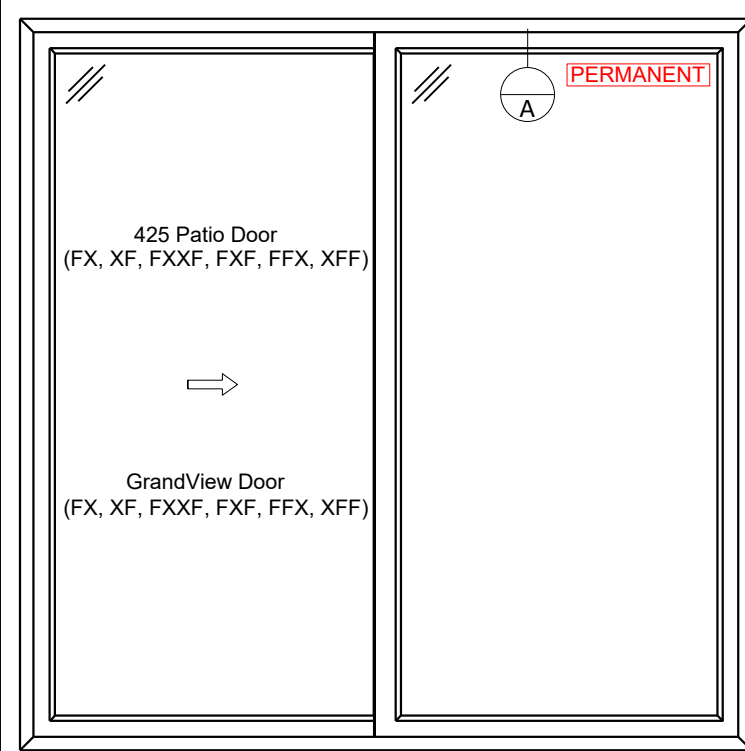
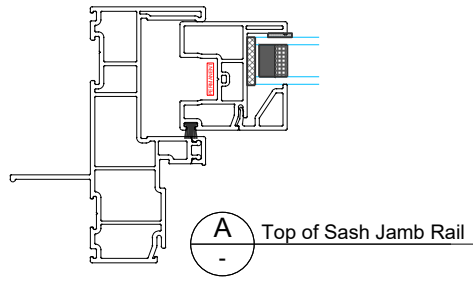

425 Patio Door (FX, XF, FXXF, FXF, FFX, XFF)

GrandView Door (FX, XF, FXXF, FXF, FFX, XFF)

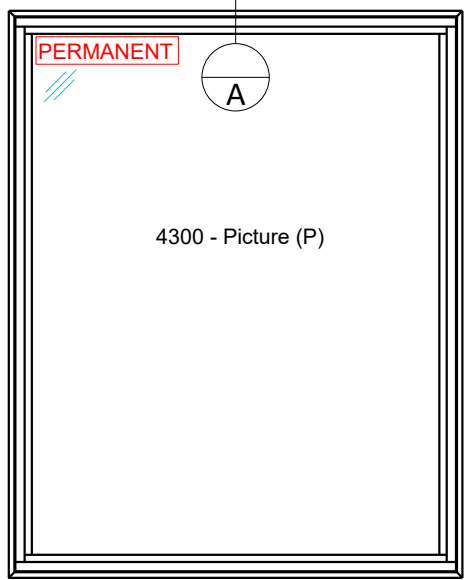
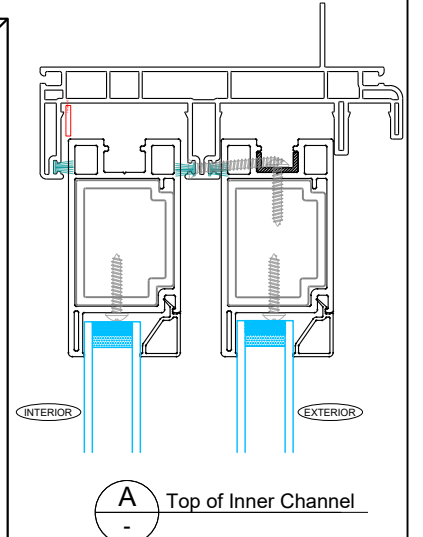

4300 - Picture (P)

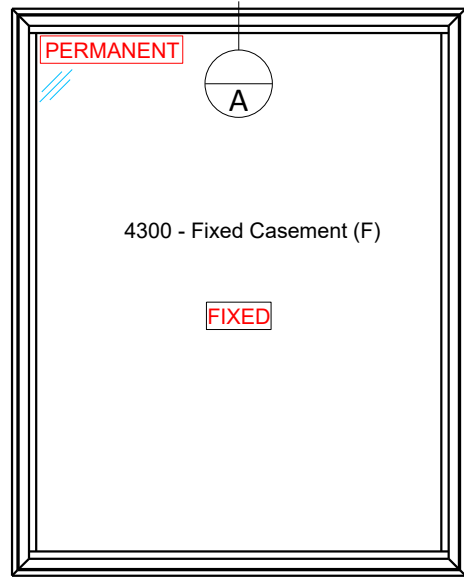
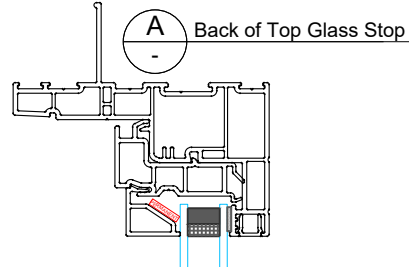

4300 - Fixed Casement (F)

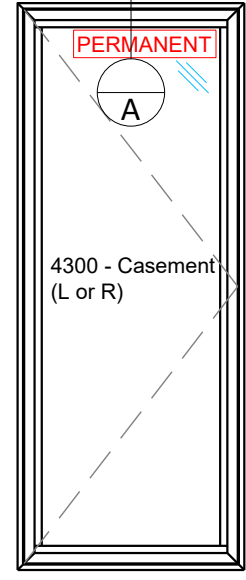
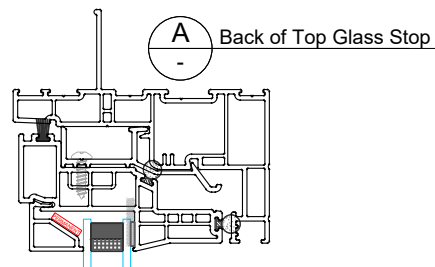

4300 - Casement (L or R)

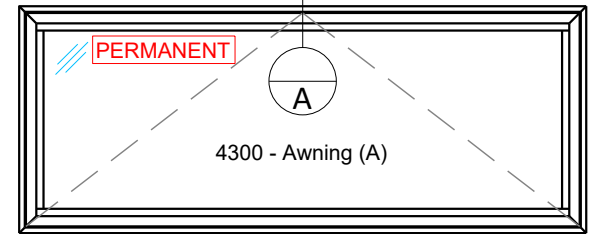
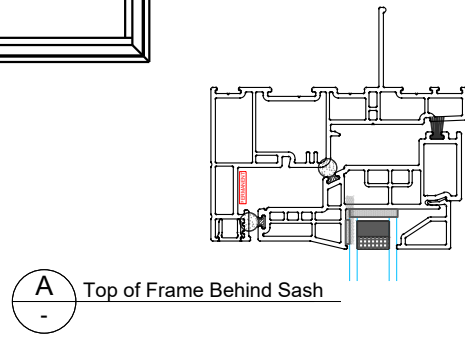

4300 - Awning (A)

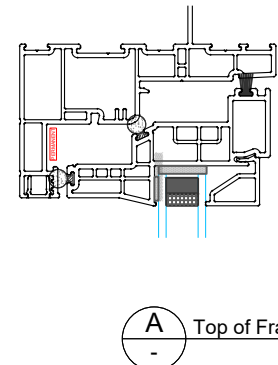

FILE PATH: F:\\_TechDept\Drawings\Drafting Templates\Standard Operating Procedure\Product Labelling (Permanent Labels)\PVC\_LAST SAVED BY: DOUGT\_2020-10-15 3:17 PM



**FENESTRATION CANADA**  
 WESTECK WINDOWS MFG INC. 2019  
 MEMBER IN GOOD STANDING  
 THESE DRAWINGS ARE WESTECK'S CONFIDENTIAL AND PROPRIETARY INFORMATION AND SHALL NOT BE GIVEN TO ANY OTHER PERSON OR COMPANY WITHOUT WESTECK'S PRIOR WRITTEN CONSENT

REV.	DATE	DESCRIPTION	VER.	CHECKED	APPROVED
1	-	-	-	-	-
2	-	-	-	-	-
3	-	-	-	-	-
4	-	-	-	-	-
5	-	-	-	-	-

PVC Products  
 Permanent Labelling

SCALE	AS SHOWN
DATE	2020-10-15
DRAWN BY	DOUGT
SALES REP	-

DRAWING NUMBER	-
----------------	---