

Glass Removal and Replacement Aids

Plus
One
inch to
width
and
height

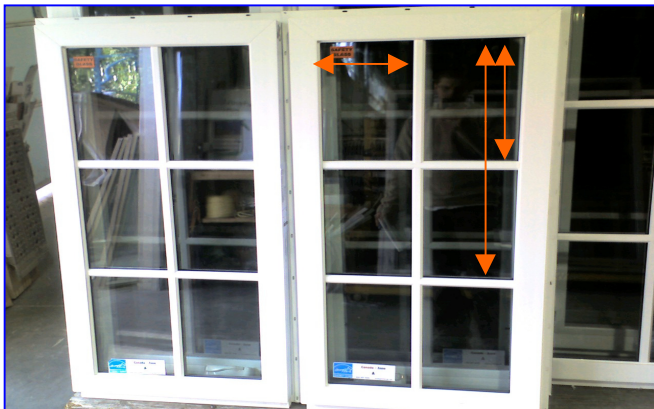

Here you see indicated by arrows vinyl touching glass to where vinyl is touching glass WxH– this is referred to as ‘DLO’ or daylight opening. One inch is added to width and height to gain actual sealed unit size required. (or ½” all way around more specifically)



From top DLO
edge to ***centre of
grid bar*** and add
½ inch. Be sure to
provide a sketch
with dimensions
and grid type.

For Grids, Measure from DLO of top of glass to the centre of the horizontal grid bar, and add ½”. Do the same with the vertical bar. Measure from DLO of glass on the side to the centre of the vertical bar, and add ½” For any window product, be certain to report width first, then height, or your unit may be made incorrectly.

Switching a Glass unit:

Fixed and Sash unit 2000 and PD, sash only 4000, or 5000,

Measure new glass to ensure correct sizing. Using olfa knife, cut tape around perimeter between glass and vinyl. (From inside of building/window) You will need to get the blade in ½”+ as this is the width of the glazing tape. You may choose to remove some bead to relieve tension prior to cutting (at your own risk), but do not remove all as you will be in danger of the unit falling out pre-maturely and causing injury.

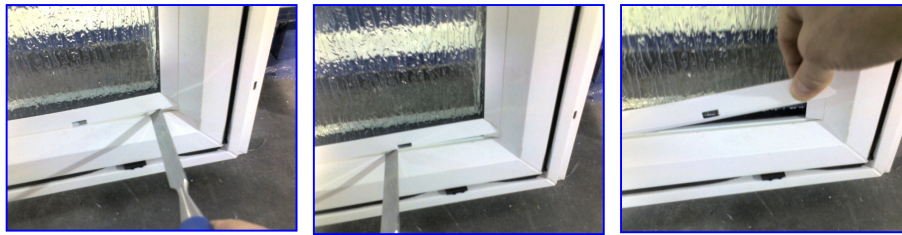

Use a chisel in a twisting motion to remove bead. Once started the bead should pull out easily – ensure that on the bead with drainholes you use the chisel until past the drainhole to avoid kinking the bead when you pull it out.

The unit should be loose – remove unit. Use chisel to clean from glazing surface and re-tape, beginning at top corner. The two sided tape should have a plastic layer (usually blue in color) that protects the tape from sticking to itself. Pull in this protective layer at corners to use as a starting point for when you will pull the rest of it off. Place setting blocks. Place in new unit, & pay careful attention to sightlines, and square of unit. Pull tape plastic layer slowly, & apply light pressure on perimeter of unit to adhere it to the frame. Once tape is all pulled, and unit stuck, re-insert bead.

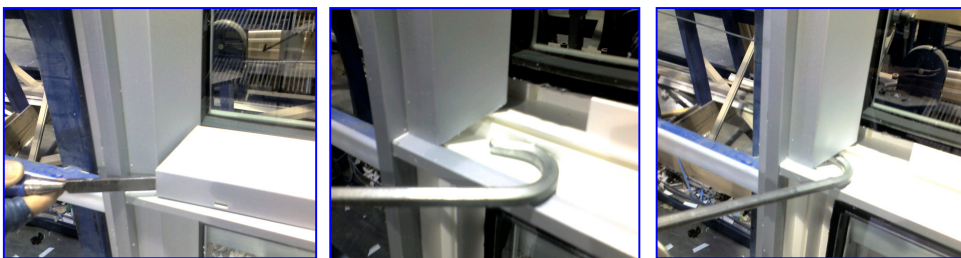

For 4000, 5000 Picture pry out bead with chisel, and pry bar - horizontals first (above). Have a helper on outside, or a suction cup on inside (to ensure unit doesn't fall) and cut out unit as above ½”+ all way around. Remove unit. Use chisel to clean tape surface and re-tape, beginning at top corner. Pull in tape corner to use as a starting point. Place setting blocks. Place in new unit, paying careful attention to sightlines. Re-insert bead, pushing with thumbs or palms until a click is heard. verticals first, horizontals last.

The tempered 'bug' or 'etching' is typically located at the bottom corner. Our supplier etches the tempered and Westeck also etches the unit after sealing.